

PART No. 9382321000-03

SETTING MANUAL

Wireless LAN control for air conditioner

Before using this product, read these instructions thoroughly and keep this manual for future reference.

Items to Check

• Prepare the following items before using this product.

Wireless Router	This product uses a wireless router that supports IEEE802.11b/g/n wireless LAN standard. Set the connection to the wireless router with WPS to perform communications by wireless LAN. Refer to the operation manual of the wireless router you wish to use, if it supports IEEE802.11b/g/n or WPS.
Smartphone or Tablet PC	Required OS version: Android OS 4.1 or later iOS 8.0 or later

Android and Google Play are registered trademarks of Google Inc. App store is a service mark of Apple Inc., registered in the U.S. and other countries. IOS is a trademark or registered trademark of Cisco in the U.S. and other countries and is used under license.

For information on Wireless LAN (WLAN) control, please refer to the following web site.

<http://www.fujitsu-general.com/global/support/>

Name of Parts

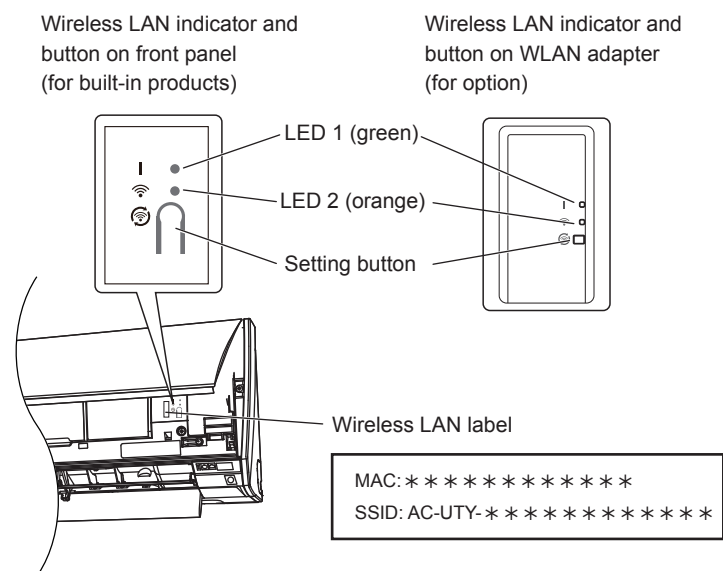

NOTES

- The wireless LAN label located beside the wireless LAN indicator is necessary for wireless LAN setup.
- Be sure to keep the wireless LAN label attached to the indoor unit by writing the details down or pasting it on the list in the last section of this manual.
- The wireless LAN indicator and button is located either on the front panel or attached on the outside of the indoor unit. If on the front panel, open the intake grille to access. (Refer to the operating manual of the air conditioner.)
- The shape of the LED display and Setting button may differ from the illustration above depending on the product.

1. SAFETY PRECAUTIONS

- ◆ To prevent personal injury, or property damage, read this section carefully before you use this product, and be sure to comply with the following safety precautions.
- ◆ Incorrect operation due to failure to follow the instructions may cause harm or damage, the seriousness of which is classified as follows:

WARNING	This mark indicates procedures which, if improperly performed, might lead to the death or serious injury of the user.
CAUTION	This mark indicates procedures which, if improperly performed, might possibly result in personal harm to the user or damage to property.
This mark denotes an action that is PROHIBITED.	This mark denotes an action that is COMPULSORY.

WARNING	
	<ul style="list-style-type: none"> • This product contains no user-serviceable parts. Always consult authorized service personnel for repairing, installation, and relocation of this product. Improper installation or handling will cause leakage, electric shock, or fire. • In the event of a malfunction such as burning smell, immediately stop operation of the air conditioner, and disconnect all the power supply by turning off the electrical breaker or disconnecting the power plug. Then consult authorized service personnel.
	<ul style="list-style-type: none"> • Do not repair, disassemble or remodel this product. • Do not get this product wet or use it in locations with lots of moisture. • Do not operate with wet hands. • Do not install this product in locations where the use of wireless equipment is prohibited (e.g. hospitals). • Do not use this product near persons with a pacemaker or similar devices. • Do not use this product near automatic control equipment (e.g. automatic doors and fire alarms).

CAUTION	
	<ul style="list-style-type: none"> • Disconnect all the power supply when you are not using this product for extended periods.
	<ul style="list-style-type: none"> • Do not stand on slippery, uneven or unstable surfaces when you operate the unit. • Do not press the buttons of this product any more strongly than is necessary.

2. USAGE PRECAUTIONS

- When you use this product, it will become possible to operate the air conditioner from locations where you cannot see it directly. This means that people in the room may be exposed to the unintended operation of the air conditioner. Check the condition of the room before using this product.
 - **Be sure to check on a regular basis that the power supply to the air conditioner is securely connected, and that dust has not built up in the surrounding area.** It may cause heating, or fire.
 - **Be sure to check in advance that there are no malfunctions of the air conditioner.**
 - **Be sure that the airflow from the air conditioner will not cause any adverse effects.** Objects may fall down causing personal injury, fire, or damage to property.
 - **If you know that there are people in the vicinity of the air conditioner, inform them in advance that you will be operating and stopping it from a distant location.** Sudden operation or stopping of the air conditioner may surprise a person and cause the person to fall down or tumble if the person is on a stand. Furthermore, rapid changes in the outside temperature/room temperature may cause deterioration in a person's physical condition. Do not use this product when there are people in the room who are not able to control the temperature by themselves (For example, infants, children, those with physical disabilities, elderly or sick persons.).
 - **Fully understand the reserved timer settings and other operations before using this product.** Unexpected operation or stopping of the air conditioner may cause deterioration in a person's physical condition or an adverse effect on animals or plants.
 - **Frequently check the settings and operating situation of the air conditioner when using this product from a distant location.** Rapid changes in the outside temperature/room temperature may cause deterioration in a person's physical condition or an adverse effect on animals or plants.
- If you operate the air conditioner from this product, there will be no flashing of the indicator lamps, nor any reception sounds from the air conditioner.
- If there is bad reception between this product and the wireless router, adjusting the wireless router position or direction of the antenna may improve the reception. It may also be possible to improve reception by moving the wireless router closer to this product or using a wireless LAN repeater.

3. WIRELESS LAN USAGE PRECAUTIONS

When you use a wireless LAN, there are precautions that you must follow in relation to radio waves, personal information, and so on. To use this product correctly, be sure to read the following precautions and the operating manual of the wireless LAN equipment you are using. We will assume no responsibility, unless legal liability is recognized, in regards to failures, other defects and damages incurred by use of this product that occur through incorrect use or during use by yourself or a third party.

3.1. Radio wave usage precautions

CAUTION	
Changes or modifications not expressly approved by the party responsible for compliance could void the user's authority to operate the equipment. This transmitter must not be co-located or operated in conjunction with any other antenna or transmitter.	
This equipment complies with FCC/IC radiation exposure limits set forth for an uncontrolled environment and meets the FCC radio frequency (RF) Exposure Guidelines and RSS-102 of the IC radio frequency (RF) Exposure rules. This equipment should be installed and operated keeping the radiator at least 20cm or more away from person's body.	

NOTES

This device complies with Part 15 of FCC Rules and Industry Canada license-exempt RSS standard(s). Operation is subject to the following two conditions:

- (1) this device may not cause interference, and
 - (2) this device must accept any interference, including interference that may cause undesired operation of this device.
- Do not use this product in the following locations. Using this product in such locations may cause communications becoming unstable or not possible.
 - Near wireless communication equipment that uses the same frequency band (2.4GHz) as this product.
 - Places where there are magnetic fields from equipment such as microwave ovens, or static electricity or radio wave interference occurs. (Radio waves may not reach depending on the environment.)

3.2. Personal information (security-related) usage precautions

- There is a possibility of interception if you use wireless LAN equipment due to the use of radio waves regardless of whether you use encryption or not.
- Wireless LAN uses radio waves to exchange information between this product and the wireless router. This means it has the advantage of freely being able to make a LAN connection if within reach of radio waves. On the other hand, if the radio waves are within a certain range, they will reach all locations beyond obstacles (e.g. walls). Therefore, it is possible your communications may be intercepted and read or illegally intruded upon.
- Do not connect to equipment and networks which you are not authorized to use when setting up your wireless connection.
- Initialize the settings of this product when disposing it, or transferring it to a third party.

3.3. Others

- Use this product as regular wireless LAN equipment.
 - Do not use this product in hospitals or in/near locations with medical equipment.
 - Do not use this product within aircraft.
 - Do not use this product near electronic equipment that handles high-precision control or weak signals.
- Examples of electronic equipment to be careful of:
 - Hearing aids, pacemakers, fire alarms, automatic doors and other automatic control equipment
- This is not a guarantee of wireless connection and performance with all wireless routers and in all residential environments. Radio waves may not reach or may be interrupted in the following situations.
 - Use in buildings made from concrete, rebars or metal
 - Installation near obstacles
 - Interference with wireless communication equipment using the same frequency
 - Places where there are magnetic fields from equipment such as microwave ovens, or static electricity or radio wave interference occurs
- Install and setup this product only after reading the operating manual of the wireless router.

4. PREPARATIONS FOR USE

4.1. Application software installation

- 1 Open "Google Play" or "App Store" depending on the type of your smartphone or tablet PC.**
- 2 Search for "FGLair".**
- 3 Install the application software (mobile app) following the instructions on your screen.**

4.2. User registration

- 1 Open the installed mobile app.**
- 2 Register the user (with either a smartphone or tablet PC) by following the instructions in the create an account section of the mobile app.**

4.3. Air conditioner registration

Choose from the following modes to connect your air conditioner to your wireless router.

NOTES:

- Before starting this setting, wait for **60 seconds** or more after the power supply is connected to the air conditioner (via breaker or plug).
- If both LED 1 and 2 are off, the WLAN adapter may be in Sleep mode. Be sure it is deactivated before setting up the wireless LAN. (Refer to "5. SLEEP MODE")
- Check that the smartphone or tablet PC is linked to the wireless router you are connecting the air conditioner. The setting will not work if it is not connected to the same wireless router.
- To control 2 or more air conditioners with the same smartphone or tablet PC, repeat the setup of the chosen mode.
- The display contents are subject to change as a result of updates in the mobile app, and may not match the actual screen.

4.3.1 Button Mode

*Lighting pattern: ○ Off ● On ✨ Flashing

1 Launch the mobile app.

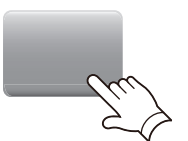

2 Sign in with your Email address and password (as registered in "4.2. User registration") following the screen on the mobile app.

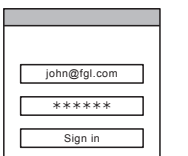

3 Press the [+] button to add a new air conditioner.

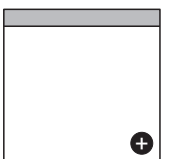

4 Confirm that LED 2 is flashing. (On/off at 2-second intervals.) Then select [Button mode] on the screen.

If LED 1 and 2 are off, push the Setting button once. (Refer to "5. SLEEP MODE".)

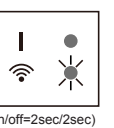
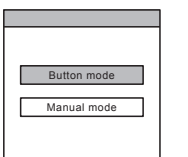

5 Press the WPS button on the wireless router that you are connecting to.

Refer to the operating manual of the wireless router for the location of the button and how to press it.

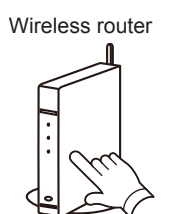

Continues on the reverse side →

6 Confirm that LED 2 is flashing. (On/off at 2-second intervals.) Then press and hold the Setting button on the WLAN adapter for 3 seconds.

LED 2 lighting will change. (on/off: 2sec/2sec → 2sec/0.5sec)

Confirm that the LED 1 and 2 is both on to proceed.

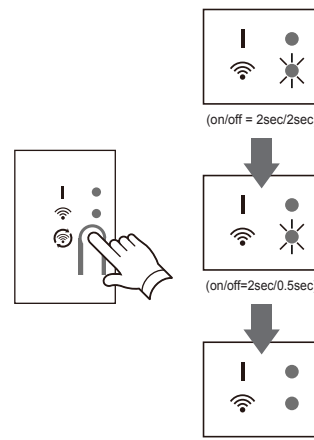

7 Press [Register] to start the connection with the wireless router.

LED 1 and 2 will both flash 2 times, and a message will appear when setup is complete.

It may take a few minutes before the message appears on the screen.

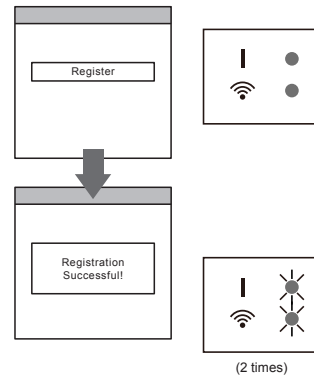

4.3.2 Manual mode

*Lighting pattern: ○ Off ● On ☀ Flashing

1~3 See steps 1 to 3 in "4.3.1. Button mode".

4 Select [Manual mode].

If LED 1 and 2 are off, push the Setting button once. (Refer to "5. SLEEP MODE".)

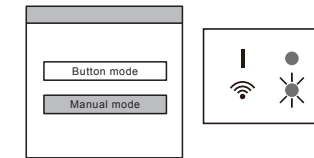

[For Android]

5 Select the SSID of the air conditioner you are connecting to.

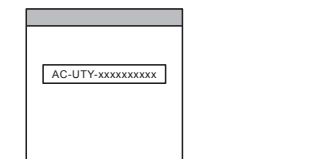

6 Select the SSID of the wireless router you are connecting to. Input the wireless router (WLAN access point) password then press [Connect device].

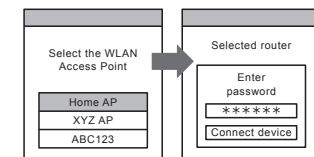

7 LED 1 and 2 will both flash 2 times, and a message will appear when setup is complete.

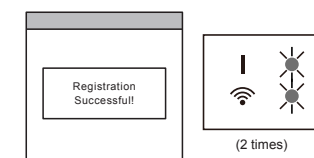

[For iOS]

5 Select [Open WLAN setting] or activate the wireless LAN by pressing the Home button -> [Setting] -> [Wi-fi]. Select the SSID of the air conditioner you are connecting to.

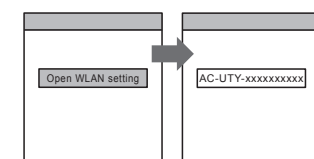

6 Select the SSID of the wireless router you are connecting to. Input the wireless router (WLAN Access Point) password then press [Connect device].

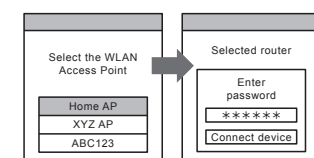

7 LED 1 and 2 will both flash 2 times, and a message will appear when setup is complete.

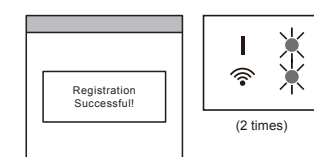

5. SLEEP MODE

*Lighting pattern: ○ Off ● On ☀ Flashing

When the WLAN adapter is not used

- The WLAN adapter will turn to Sleep mode when the WLAN setup is not completed within an hour after the power supply is connected to the air conditioner (via breaker or plug).

- The WLAN adapter cannot be used during Sleep mode. The WLAN adapter will be nonfunctional, and both LED will turn off.

To use the WLAN adapter

- Press the Setting button of the WLAN adapter. Confirm that the LED lighting has changed.

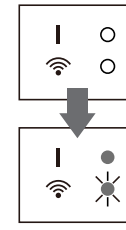

LED1: On
LED2: 2sec/on
2sec/off

6. INITIALIZATION (Reset)

Initialize (reset) this product in the following situations:

- Changing the wireless router
- Disposing this product
- Transferring this product to a third party

- Unregister the air conditioner
Unregister the air conditioner by using the mobile app. (Refer to the operation manual of the mobile app for details.)

- Initialization of the WLAN adapter

*Lighting pattern: ○ Off ● On ☀ Flashing

1 Press and hold the Setting button for 10 seconds.

2 The initialization will be complete when all LED lamps flashes 3 times simultaneously (on/off at 0.5-second intervals).

LED 1 will flash. (on/off=2sec/0.5sec)
After 60 seconds, the LED lamps will return to the original lighting pattern. (LED1: on, LED 2: on/off=2sec/2sec)

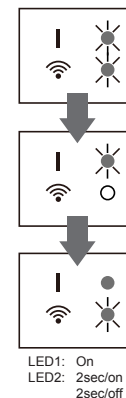

LED1: On
LED2: 2sec/on
2sec/off

- To continue use

If you or a third party wishes to continue use of the product, follow the procedures in "4. PREPARATIONS FOR USE" to reconnect to a different wireless router.

NOTES:

Wireless LAN setup is not possible, if the previous owner did not unregister or initialize this product. In this case, please contact your authorized service personnel.

7. OPERATING TIPS

- For how to operate the mobile app, refer to the operating manual of the mobile app.
- You can only register 1 Email address and password per WLAN adapter. To add other users (smartphone or tablet PC) to the same WLAN adapter, please use the same Email address and password.
- The air conditioner settings from the mobile app will not be reflected in the wireless remote controller.
- It will not be possible to give operation instructions or carry out monitoring from the mobile app while the power supply is disconnected from the air conditioner (via breaker or plug).
- The room temperature will be displayed in the mobile app during operation. However, the displayed room temperature may not be correct depending on the situation in the room, or the air conditioner operating status. Use this only as a reference.
- If the mobile app and remote controller settings differ, the latest operation performed will take priority.
- If timer settings are done from the mobile app and from the wireless or wired remote controller, both timer settings will be active.

8. SPECIFICATIONS

Wireless LAN-compatible standard	IEEE802.11b/g/n
----------------------------------	-----------------

9. TROUBLESHOOTING

Check the following items before requesting repairs to this product.

Parts/Elements	Situation	Solutions
Mobile app (Download and account registration)	I don't know how to download the mobile app.	Refer to "4.1. Application software installation".
	I am not able to use the mobile app	Check that the version of the OS on your mobile device is supported. Refer to "Items to Check".
	I have not received the e-mail when registering my account	Set the domain permissions so that it is not rejected as spam.
	The method of registering additional users is unclear	You can only register 1 Email address and password per WLAN adapter. Use the same Email address and password for other users to operate through the same WLAN adapter.
	The method of registering additional air conditioners is unclear	To register additional air conditioners, repeat the setup of the chosen mode in "4.3. Air conditioner registration" for each air conditioner.
Wireless LAN setup and initial settings	Wireless LAN setup is not possible	Check that your wireless router supports "WPS function". (Button mode) Check if there was any previous owner using this wireless LAN control. If there was a previous owner, please contact authorized service personnel.
	Wireless LAN setup is not possible (The connection settings of the WLAN adapter and router are not complete)	Check that your wireless router supports "IEEE802.11b/g/n". (Check with the operating manual of the wireless router.) Check that the WLAN adapter of the indoor unit is on. (Check that the LED of your WLAN adapter is lit or flashing.) • If the LED is set to turn off in the mobile app, it will not light up or flash.
	Operations from the mobile app	I am not able to operate this product from the mobile app Check that the power to the indoor unit is on. Check that the power to the wireless router is on. Check that your smartphone is not in flight mode. Check that you are not in a place where it is difficult to make a connection with radio waves. Check that the WLAN adapter is not in Sleep mode.

State of the Wireless LAN indicators

*Lighting pattern: ○ Off ● On ☀ Flashing

State of the Lamps	Causes and Solutions
All the lamps are off	The power to the WLAN adapter is not on. → Check that the power to the air conditioner is on and that the air conditioner breaker has not blown. The WLAN adapter may be in Sleep mode. → Push the Wireless LAN button, then check if the LED turns on. The LED lamps are turned off by setting from the mobile app. → Refer to the operating manual of the mobile app.
LED 2 is off or flashing fast (Repeating 0.5 seconds on / 0.5 seconds off)	The power to the wireless router is not on. → Check that the power to the wireless router is on. There is a possibility that the WLAN adapter is not properly connected to the wireless router. → Disconnect the power supply to the air conditioner (via breaker or plug), and then re-connect.
LED 1 is flashing fast (Repeating 0.5 seconds on / 0.5 seconds off)	It is not possible to communicate with the air conditioner. → There may be a wiring error in the air conditioner. Please contact authorized service personnel.
All the lamps are flashing fast (Repeating 0.5 seconds on / 0.5 seconds off)	There is a problem with the WLAN adapter. → Disconnect the power supply to the air conditioner (via breaker or plug), and then re-connect. Setup the wireless LAN again according to the procedures in "4. PREPARATIONS FOR USE".

If the problem persists even after you perform these checks or diagnostics, consult authorized service personnel.

10. SETTING DETAILS

Record the setting details in the following table.

Setting information

SSID	
MAC address (MAC)	
System commissioning date	

Installer contact details

Name	
Telephone no.	